



SALTO

SALTO Systems I Security (European models) escutcheon inspired **access**

MIFARE
DESFire



LEGIC
innovation in ID technology



XS4 Security narrow body version

Smart, secure and innovative, XS4 Security Electronic handle sets need no hard wiring and provide a totally wire-free networked electronic locking solution with a great range of features.

The security model has been specially designed to fit on most Euro profile doors, and work with the majority of European mortise locks and cylinders bringing all the benefits of a networked system through the SALTO Virtual Network(SVN). The SALTO security range is ideal for use on doors where a higher level of security protection is required. Their tough vandal resistant construction protects the locks against attack and unauthorised entry, without losing the access flexibility or control of the system.

They offer a wide range of options when used in multiple applications with other systems using the same card. With simple, intuitive use and ID carriers available in many formats, this system is ideally suited for special needs applications.



▶ About the SALTO Security Escutcheon

▶ Opening modes



- **Standard** (locked at all times).
- **Office** (free passage ability).
- **Timed Office** (free passage with automatic locking).
- **Automatic Opening** (8 pairs of "hands free" timed lock and unlocks per day, including holidays).
- **Automatic Opening + Office**.
- **Toggle** (present card to lock, present card to unlock).
- **Timed Toggle** (automatic locking at end time).

▶ Access Control Features



	i-Button Self programmable system	i-Button ROM system	RW system
Maximum number of users per system:	1000	1000	4000000
Maximum number of doors per system:	1000	64000	64000
Maximum events on lock audit:	-	1000	1000
Timezones:	-	30	256
Timeperiods:	-	20	256
Calendars in system:	-	4	256
Zones in system:	-	unlimited	unlimited
User groups:	-	unlimited	unlimited
Management:	Programming key and users key sets	Pro Access ROM software	Pro Access or HAMS software (available SQL versions) and MS Service



ID technologies

SALTO XS4 Double reader escutcheon is available in i-Button and in different RFID technologies* (DESfire, DESfireEV1, Mifare, Mifare plus, Ultralight C, Legic, HID iCLASS®, Inside Picopass and SKIDATA allowing multi-application with third party systems using one card).



Mifare DESfire features



MIFARE DESFire

Mifare RFID contactless technology reads and writes information to contactless smart cards (RFID) compatible with ISO 14443A, ISO 14443B and ISO 15693 standards, and as Mifare, Mifare Ultralight C, DESfire, technologies. They also allow for updating the carriers via SALTO Virtual Network (SVN) technology.

These SALTO electronic locks are compatible with NFC (Near Field Communication) technology, which allows NFC enabled cell phones to act as contactless data carriers to open and control SALTO access controlled doors.

- 13.56MHz contactless RFID identification.
- ISO 14443A, ISO 14443B and ISO 15693, Mifare, DESfire Compatible.
- Near Field Communication (NFC) compatible.
- Key card memories available: 1Kbyte, 4Kbytes and 8 Kbytes depending on technology.
- Key shape available: ISO 7810 Cards, fobs, bracelets, stickers, watches...
- Reusable key cards.
- SALTO Virtual Network (SVN) compatible².
- RFID technology, there's a contactless exchange of information between the card and the reader.
- High security encrypted Proximity cards.
- Multi-application with other systems using the same card through shared sectors.
- Customized card issuing through the SALTO Authentication Media software (SAM).
- Waterproof cards, which can be customized.

HID iCLASS features



iCLASS® contactless technology from HID is RW identification technology based on 13.56 MHz read/write contactless smart card technology. iCLASS® offers enhanced security through encryption. This single-card, contactless solution permits multi-application with others systems, and with the SVN capabilities, you will acquire a lot of interesting new features for your property access control.

- 13.56MHz contactless RFID identification.
- ISO 14443B2 standard compliant.
- ISO 15693 standard compliant.
- Reusable key cards.
- SALTO Virtual Network (SVN) compatible².
- RW technology, there's a contactless exchange of information between the card and the reader.
- High security, by using password and encrypted Proximity cards.
- Multi-application with other systems using the same card through shared pages.
- Customized card issuing through the SALTO Authentication Media software (SAM).
- Waterproof cards, which can be customized.

¹ All the technologies cannot be implemented in one escutcheon (one technology per escutcheon)

LEGIC features



LEGIC Identsystems includes highly integrated LEGIC RF Standard and ISO 15693 and ISO 14443 compliant RW Chip Sets, Security Modules and Transponder Chips for integration into third party products. A very good option if you already use a LEGIC transponder system.

SALTO LEGIC electronic escutcheons are LEGIC Prime and advant compatible on the same device.

- 13.56MHz contactless RFID identification.
- Key card available: 256bytes (LEGIC Prime),1024bytes (LEGIC Prime).
- Key shape available: ISO 7810 Cards, fobs, bracelets, stickers, watches...
- Reusable key cards.
- SALTO Virtual Network (SVN) compatible.
- RW technology, there's a contact less exchange of information between the card and the reader.
- High security, by using password and encrypted Proximity cards.
- Multi-application with other systems using the same card through shared pages.
- Customized card issuing through the LEGIC SAM protocol.
- Waterproof cards, which can be customized.

Picopass features



Picopass is a family of contactless memory chips that support both ISO14443B and ISO 15693 proximity and vicinity protocols. It allows for updating of carriers via SALTO Virtual Net (SVN) technology, is simple to use and offers a range of options including multiapplication with other systems using a picopass contactless card system.

- 13.56MHz contactless RFID identification.
- ISO 14443B proximity protocols for high speed communication range of 10 cm.
- ISO 15693 (Vicinity protocol) to operate at lower speeds over longer ranges.
- Reusable key cards.
- SALTO Virtual Network (SVN) compatible².
- RW technology, there's a contact less exchange of information between the card and the reader.
- High security, by using password and encrypted Proximity cards.
- Multi-application with other systems using the same card through shared pages.
- Customized card issuing through the SALTO Authorization Media software (SAM).
- Waterproof cards which can be customized.



Contact less key cards



Contact less fobs



Contact less bracelets



Contact less watches



NFC phones

Consult SALTO for the carriers availability, not all the carriers are available for all the RFID Technologies

² Just available in the RW systems

i-Button Smile features



The i-Button technology is a robust and ergonomic technology due to the design of the fob and the lock. Smart, secure and innovative, SMILE XS4 electronic handle sets need no hard wiring and provide a modern solution to the problem of lost keys or masterkeys. No software or computer is required for programming the SMILE handle sets.

- Access given through contact by electronic i-Button.
- Simple and intuitive use due to the smart design of the i-Button and the electronic lock reader.
- A red programming tag controls 1 or more SMILE locks in a system.
- Programming card and users cards are always supplied with a shadow card that can be filed away and can be used to delete lost keys from the memory lock.
- Complete lock reset option.
- Handle sets can be programmed to be set in passage mode.
- Passage mode setting can be restricted to authorized users only.
- Extremely resistant system, suitable for all kind of environments.
- High security, by using password and encrypted i-Button fobs.
- i-Buttons can be customized by numeration.
- i-Buttons are water proof.

i-Button ROM features



The i-Button technology is a robust and ergonomic technology due to the design of the fob and the lock. This mid-range ROM system allows you to audit a large number of events in your locks.

- Access given through contact by electronic i-Button.
- Simple and intuitive use due to the smart design of the i-Button and the electronic lock reader.
- Extremely resistant, system suitable for all kind of environments.
- Different sort of i-Button fobs or bracelets available.
- Reusable keys.
- High security, by using password and encrypted i-Button fobs.
- i-Buttons can be customized by numeration.
- i-Buttons are waterproof.

i-Button RW features



The i-Button technology is a robust and ergonomic technology due to the design of the fob and the lock. Compatible with data on card technology SALTO Virtual Network (SVN) system that allows you to control all the doors in an entire building or group of buildings from a single PC.

- Access given through contact by electronic i-Button.
- Simple and intuitive use due to the smart design of the i-Button and the electronic lock reader.
- Extremely resistant system, suitable for all kind of environments.
- 512bytes or 2Kbytes i-Button fobs or bracelets available.
- Reusable keys.
- SALTO Virtual Network (SVN) compatible.
- High security, by using password and encrypted i-Button fobs.
- i-Buttons can be customized by numeration.
- i-Buttons are waterproof.



Fobs



Bracelets

▶ Mechanical features



- Dimensions: 280mm x 42.5mm x 22mm.
- Weight: 2.2kg.
- Handle turning angle: 30°.
- Spindle compatibility: 7mm, 8mm or 9mm.
- Door thickness compatibility: 30mm to 115mm.
- Distance from the handle to the cylinder: 47mm to 110mm.
- Clutch mechanism of the mortise lock deadbolt.
- Inside always allows opening (anti panic in combination with lock).
- Body and escutcheon made out of steel.
- Covers finished in stainless steel or brass.
- Handle fixed by Steady Fix system (patented).
- Handles compatibility: 16mm Ø, 18mm Ø.
- Extreme security through advanced hardened high resistance anti-drill plates to protect wires and reader area.

▶ Mortise lock compatibility



- DIN Locks.
- European Locks.
- Metal millwork.
- Multi-point locks.

▶ Squared spindles compatibility



- 8mm and 9mm.

▶ Electronic features



- Wire free stand alone networked system through SVN technology*.
- Locks are connected to the system through the SALTO Virtual Network improving the security and efficiency of the system*.
- Non volatile memory (is not deleted, even without power).
- Electronic privacy option through thumbturn or button in the inside escutcheon. This blocks all the carriers from operating the lock, except management master keys which will always override this privacy mode to gain entry in case of emergency.
- Escutcheons are equipped with a low consumption real time clock function, which allows time zones access planning and to use of 256 different calendars*.
- Dual colour LED (green/red) to indicate lock authorization.
- Special blink indication when lock is in privacy mode.
- Possibility to enable/disable the acoustic signal.
- Power supply: 3 alkaline LR03 AAA 1,5V batteries. Optional FR03 lithium batteries.
- Battery autonomy up to 35 000 openings.

* Just available in the RW systems

▶ Handles



Model U



Model S



Model W



Model H



Model P



Model B



Model O



Model L



Model J



Model T



Model Y



Model Z



Model C



Model G

REF. Y (May be installed on the external escutcheon when combined with a roller shutter)

▶ Finishes



Satin stainless steel
IM



Polished stainless steel
IP



Antique brass
IA

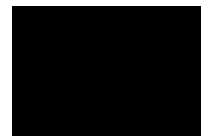

Black



White



Satin brass (PVD)
PM



Polished brass (PVD)
PP



RAL Coloured
upon request



▶ Models available



Model 20

- Any handle type inside.
- No trim outside.
- Thumbturn on both sides.

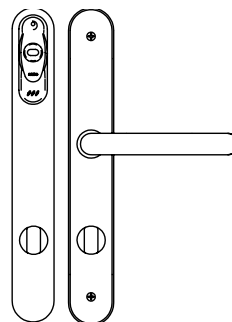

Model 21

- 2 handles any type.
- No trim outside.
- Thumbturn on both sides.

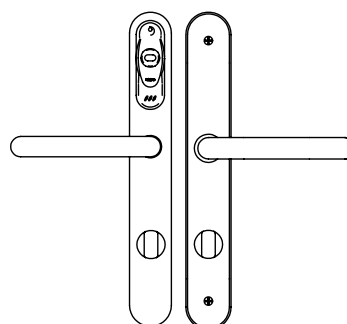

Model 22

- Any handle type inside.
- Angled pull handle.
- Thumbturn on both sides.

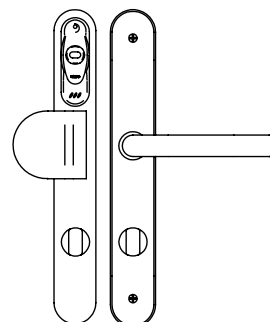

Model 23

- Any handle type inside.
- Fixed knob on outside.
- Thumbturn on both sides.

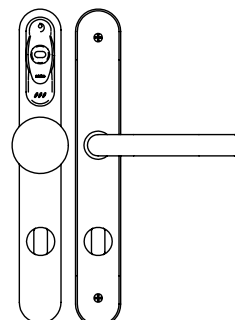

Model 26

- Any handle type inside.
- No trim outside.
- Thumbturn on both sides.
- Electronic “do not disturb” system (Not available in self programmable).

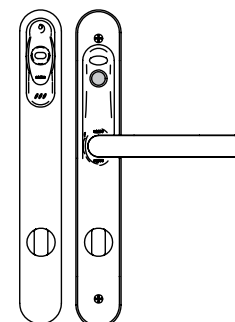

► Models available



Model 28

- 2 handles any type.
- Thumbturn on both sides.
- The handle has free travel to throw uplift multipoints bolts.

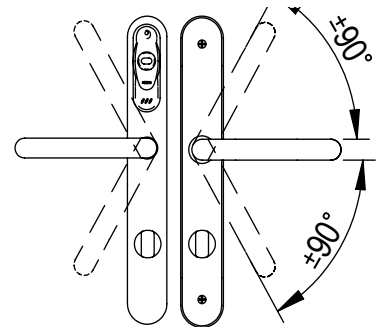

Model 29

- No handles.
- Thumbturn on both sides.



Model 30

- Any handle type inside.
- Outside thumbturn.

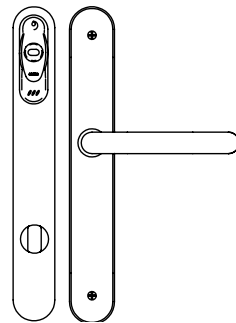

Model 31

- 2 handles any type.
- Outside thumbturn with clutch mechanism.

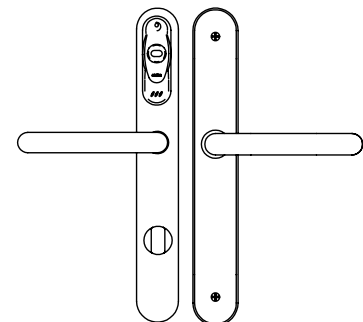

Model 32

- Any handle type inside.
- Angled pull handle.
- Outside thumbturn with clutch mechanism.

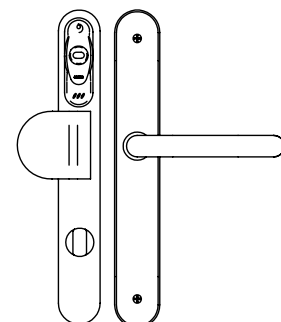

► Models available



Model 33

- Any handle type inside.
- Outside thumbturn with clutch mechanism.
- Fixed knob in the outside.

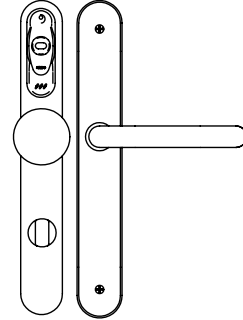

Model 36

- Any handle type inside.
- Outside thumbturn with clutch mechanism.
- Electronic “do not disturb” system (Not available in self programmable).

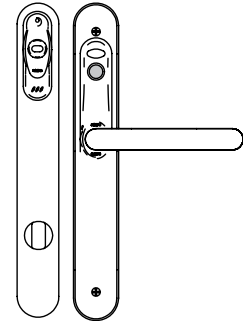

Model 40

- No handle in the inside.
- Outside thumbturn with clutch mechanism.

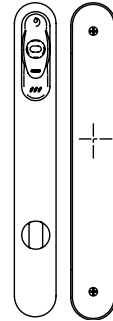

Model 41

- Outside handle any type.
- Outside thumbturn with clutch mechanism.

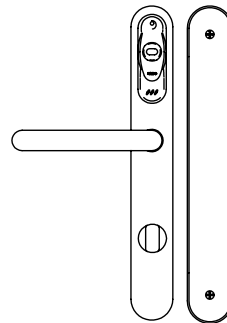

Model 42

- No handle in the inside.
- Angled pull handle in the outside.
- Outside thumbturn with clutch mechanism.

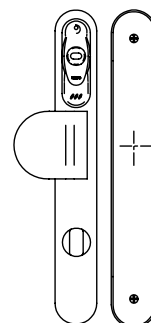

▶ Models available



Model 42

- No handle in the inside.
- Fixed knob on outside.
- Outside thumbturn with clutch mechanism.

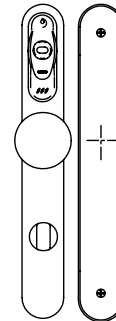

▶ Software features



- User friendly and powerful software.
- Managed through SALTO Pro Access or HAMS SQL database based software, (available in MS Service version).
- Up to 4 000 000 users.
- 64 000 doors.
- 256 calendars.
- 256 time periods.
- 256 time zones.
- Password protected operator's profiles.
- Large number of software features specially designed for the educational sector (lockdown, automatic key issuing, roll call, advanced filtering, export of the audit trail, database imports).

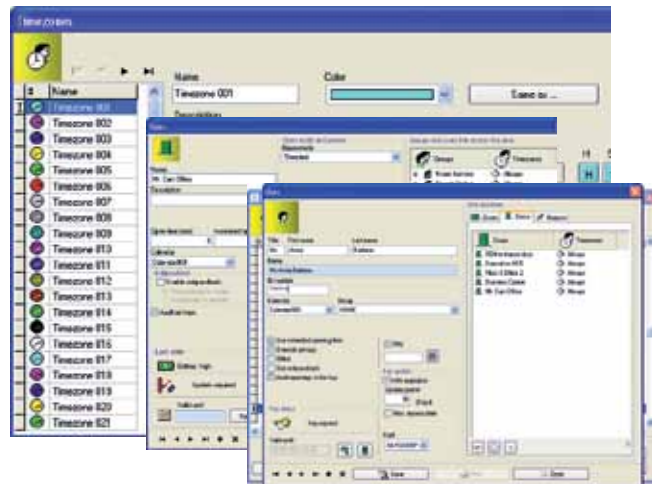

▶ RW Platform features



- Completely integrated in the SALTO Systems platform.
- Enables users to have standalone electronic cylinders, standalone electronic locks, standalone electronic glass door locks (SALTO wireless compatible), emergency exit devices (SALTO wireless compatible), locker locks and IP based on-line readers, all in the same system with SALTO Virtual Network capabilities, making it possible to update user card access plans on the fly.



► Installation



- 1 Mark the door with the SALTO template

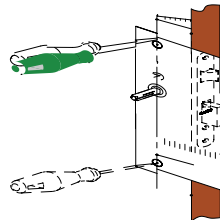

- 3 Install the XS4 external escutcheon

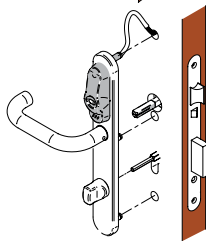

- 2 Drill two 14mm holes as shown.

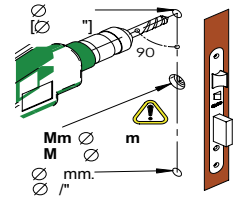

- 4 Install the XS4 inner escutcheon and connect both escutcheons.

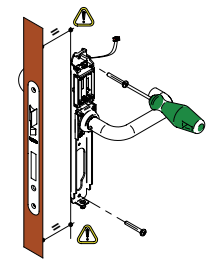

► Certifications



- RF Certification: RF60 - EN1634
- EN Certification:
 - EN 300330-1 V1.3.2 (2002-12)
 - EN 301 489-1 (2002)
 - EN 301 489-3 (2002)
 - EN 60950
 - EN 55022 (1994), class B
 - EN 55024 (1998)
 - EN 61000-6-1 (2001)
- EN 61000-6-2 (2001)
- EN 61000-4-2 (1995)
- EN 61000-4-3 (1995)

► Operating temperatures



External escutcheon: -20°C / 70°C
Inner escutcheon: 0°C / 70°C
 -20°C / 70°C (FR03 AAA using lithium batteries).

► About SALTO Systems:

Since its inception in 2001, SALTO Systems has grown to be the market leader in state-of-the-art electronic access control systems.

Recognising the need for a new access control concept, SALTO has developed a wide range of innovative products such as the SALTO Virtual Network and XS4 access control platform, while our electronic escutcheons, wall readers and on-line and off-line control units now control security access for a growing range of end users from Airports to Hospitals, Banks to Government Buildings and Universities to Hotels.

Our brand new HQ and high capacity manufacturing facility is fully equipped with the latest technology for JIT (Just in Time) manufacturing while substantial ongoing investment in a dedicated RD&I team (Research, Development and Innovation) enables us to stay at the cutting edge of modern mechanical, electronic and software design. This, together with ISO 9001:2008 and ISO 14001:2004 certification, ensures rigorous

quality management systems are in place to ensure the design, development and manufacturing of our electronic access control products always strive to achieve the highest possible standards of quality as required by you, our customers and for the environment.

Our distribution partner network now covers more than 70 countries to service international growth, and we have branch offices in Spain, UK, USA, Australia, Canada, Denmark, France, Finland, Germany, Holland, Mexico, Norway, Portugal, Singapore, Sweden and United Arab Emirates with more planned to open in other countries.

CONTACT:
 SALTO Systems HQ, Spain
 Polígono Lanbarren, C/ Arkotz, 9
 20180 Oiartzun, Spain

Tel.: +34 943 344 550
 info@saltosystems.com | www.saltosystems.com

SALTO
 inspired access

www.saltosystems.com



XS4
 BY SALTO